

Government Documents Center Help Guides

Series F - Locating Federal Materials

Part 5 - U.S. Congressional Serial Set

The Congressional Serial Set (1817+) is the most important federal historical publication in the Graduate Library. It contains recommendations by Congress on proposed legislation (used for legal histories), communications from the President to Congress such as vetoes and the budget, and some of the most important Executive Branch documents, particularly of the 19th Century. Among the latter are maps of the historic expeditions. The Serial Set was preceded by the *American State Papers*, 1789-1817 (Grad. Lib. J 33 , Microforms FILM X2516, Doc. Cen. DoX 30).

The individual subseries vary over time but include:

Type of Publication	Description
House and Senate Reports	Recommendations by committees that bills be passed into law
House and Senate Executive Reports	Recommendations on treaties and nominations to high office;
House and Senate Documents	Communications from the Executive Branch and preservation copies of some Executive Branch reports
Senate Treaty Reports	Committee recommendations on treaties
Senate Treaty Documents	Draft treaty texts

Numbering System

Each report or document may have up to five identifying numbers. The **individual Congress + report or document number** and **Serial Set number** are the most important for retrieval. The CIS Microfiche number may be necessary for fiche beginning 1970 and the SUDOCS number for paper beginning 1999.

Primary Number	Title	Vol No. for Congress and Session	Serial Number	CIS Microfiche	SUDOCS Number
Senate Report 94/2-1302	Toxic Substances Control Act	Senate Vol. 94/2 1- 11	13130-11	CIS-NO: 76-S263- 65	Y 1.1/5:94-1302
ALWAYS NEEDED FOR PAPER RETRIEVAL	Never needed	Seldom used	NEEDED FOR PAPER RETRIEVAL THROUGH 103rd (1994) and MICROFICHE (DoX30) through 1969 (91/2)	NEEDED FOR MICROFICHE RETRIEVAL (MICRO-F DoX19), 91st Congress, 2d Session, 1970+	NEEDED FOR PAPER RETRIEVAL, 106th Congress, 1st Session, 1999+

Location of Reports and Documents

Serial Vols	Time Period	Location	Retrieve By	Format
1-7915	1817 (15/1)-1921 (66/3)	Buhr	By Serial Number (e.g. Document 7913)	Paper
1-7915	1817 (15/1)-1921 (66/3)	Doc. Cen. CIS Fiche (MICRO-F DoX30)	By Serial Number (e.g. Document 7913)	Microfiche
1-7915	1817 (15/1)-1921 (66/3)	Congressional Universe http://web.lexis-nexis.com/congcomp	By Serial Number (e.g. Document 7913), subject, keyword, author, committee, petitioner, bill, law, geographic area, map relief	Internet (UMich Only)
7916-12880	1921 (67/1)-1969 (91/1)	Grad - 1 - East	By Serial Number (e.g. Document 7918)	Paper
7916-12880	1921 (67/1)-1969 (91/1)	Doc. Cen. CIS Fiche (MICRO-F DoX30)	By Serial Number (e.g. Document 7918)	Microfiche
7916-12880	1921 (67/1)-1969 (91/1)	Congressional Universe http://web.lexis-nexis.com/congcomp	By Serial Number (e.g. Document 7918), subject, keyword, author, committee, petitioner, bill, law, geographic area, map relief	Internet (UMich Only)
12881-14277	1970 (91/2)-1994 (103/2)	Grad - 1 - East	By Serial Number (e.g. Document 12883)	Paper
12881-14277	1970 (91/2)-1994 (103/2)	Doc. Cen. CIS Fiche (MICRO-F Dox19)	By CIS Fiche Number	Microfiche
14278-14531	1995 (104/1)-1998 (105/2)	Doc. Cen. CIS Fiche (MICRO-F Dox19)	By CIS Fiche Number	Microfiche
14532-14679	1999 (106/1) -2000 (106/2)	Documents Center	SUDOCS Number (e.g. Y 1.1/8:106-124)	Paper
14532-14679	1999 (106/1) - 2000(106/2)	Doc. Cen. CIS Fiche (MICRO-F Dox19)	By CIS Fiche Number	Microfiche
14680-14733	2001 (107/1)	Grad - 1 -East	By Serial Number (e.g. Document 14680)	Paper
14680-14733	2001 (107/1)	Doc. Cen. CIS Fiche (MICRO-F Dox19)	By CIS Fiche Number	Microfiche
14734-	2002 (107/2)-	Documents Center	SUDOCS Number (e.g. Y 1.1/8:106-124)	Paper
14734-	202 (107/2)-	Doc. Cen. CIS Fiche (MICRO-F Dox19)	By CIS Fiche Number	Microfiche

Obtaining Retrieval Number

IF YOU NEED	Years	SOURCE	APPROACHES
Individual Report or Document Number	1789-Present	~ <i>Congressional Universe</i> ; http://web.lexis-nexis.com/congcomp	~by subject ~by bill number ~by law number (1970+)
	1962-Present	~ <i>Statutes at Large</i> ; <i>Docs. K .U565 (also slip laws)</i>	~by law number
	1973-Present	~ <i>THOMAS</i> ; http://thomas.loc.gov	~by bill number
Serial Set Number	1817-1969	<i>CIS Serial Set Index Finding List</i> ; Doc. Cen Z 1223 .Z7 C764	~by Congress/session; report or document number
	1970-1994	<i>Numerical List</i> Doc. Cen. Z 1223 .A15	~by Congress/session; report or document number in SUDOCS order
CIS Microfiche Number	1817-1969	<i>Congressional Universe</i> ; http://web.lexis-nexis.com/congcomp	~by subject ~by bill number SAME AS SERIAL SET NUMBER
	1970-present	<i>Congressional Universe</i> ; http://web.lexis-nexis.com/congcomp	~by subject ~by bill number ~by law number (1970+)
SUDOCS Number	1999-	<i>Congressional Universe</i> ; http://web.lexis-nexis.com/congcomp	~by subject ~by bill number ~by law number (1970+)

Maps

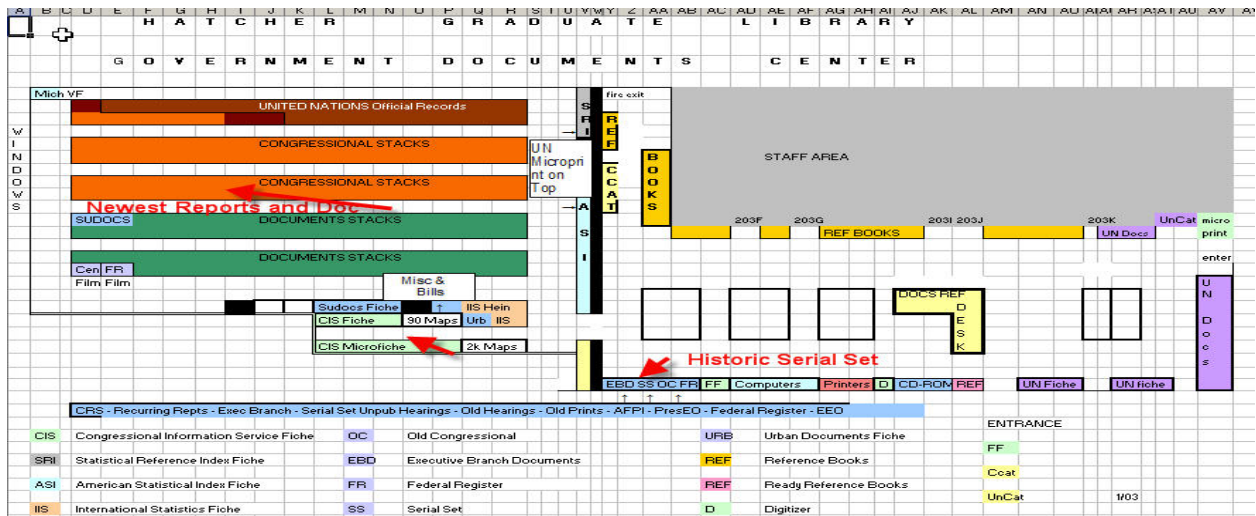

HATCHER LIBRARY FIRST LEVEL

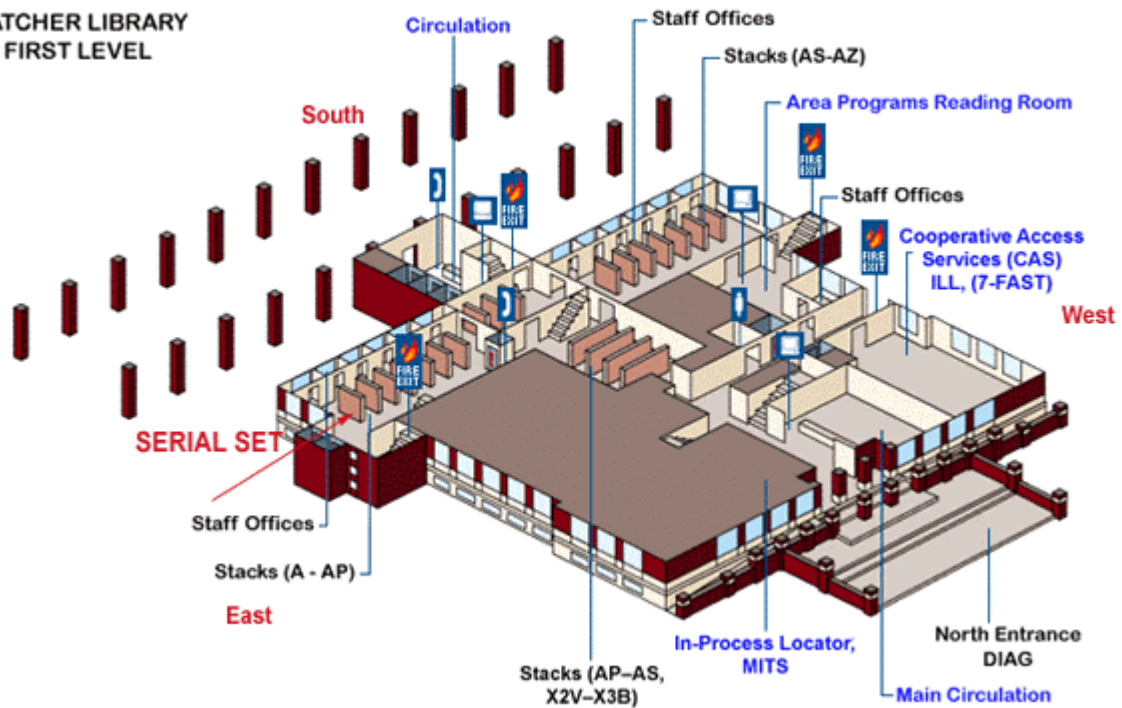

Practice Questions

1. What is the Serial Set Number of Senate Miscellaneous Document 42 of the 40th Congress, 2nd session? Where is the paper copy? Can you physically find the microfiche copy?
2. Identify the House Report on H.R. 476, the Michigan Scenic Rivers Act, 102nd Congress, 1991-92. What is the Serial Set number for the paper, and where is it located? What is the CIS number for the microfiche, and where is it located?
3. Identify the House committee report on the expulsion of Representative Bud Shuster. It was held within the past five years. Can you find it on the Documents Center shelves? If not, what is the CIS microfiche number?

ANSWERS

1. 1319. Use CIS Serial Set Finding Lists (Docs. Z 1223.Z7 C764 1975 pt. 2, v.3) You can request the paper from Buhr using the call number: Document 1319. It is also on microfiche in the Documents Center under that number.
2. Use Congressional Universe (CIS Index) by bill number to determine the report number as H.Rpt. 102-84. Fiddle with and use the Numerical List (Docs. Z 1223.A15) to determine the Serial Set Number: 14074. The CIS microfiche number should appear on the original Congressional Universe Record as: 91-H443-11. This is located in the Documents Center.
3. Use Congressional Universe (CIS Index) by subject number to determine the report number as H.Rpt. 106-979 and the SUDOCs Number Y 1.1/8:106-979. This should be on the Documents shelves. If not, the CIS number is 2000-H743-1

Government Documents Center Help Guide Series
Developed by: Lauren M. Collins, Esq., Masters Candidate
University of Michigan, School of Information
Grace York, Coordinator, Documents
University of Michigan Library
May 2003 - revised April 2006